

CERTIFIED RECORD OF LAND CORNER MONUMENTATION

DIAGRAM
T16S
R29E R30E
1/4
1 | 6

History of original corner establishment:

The original corner was set by Bamford Robb in 1870 under GLO Joint Contract #357 dated July 2, 1880 and approved March 23, 1881.

40.00 Set 12X12X4 stone in mound of stone from which;
A pine 24" diameter bears N15°E 17 links distance.

The corner was remonumented by Carl E. Sundet, LS 1664 and filed October 23, 1981. See Grant County Survey #702.

Description of corner evidence found:

Found a stone 12"X12"X4" marked "1/4" on the west face in small mound of stone. Found a ponderosa pine 25" in diameter N15°E 17 links distance to side and center, scribed "1/4S" (By Sundet).

Found a 2 1/2"X30" aluminum pipe with 3 1/4" aluminum cap 26" in ground in a mound of stone.

From which: A burned 7" Douglas Fir bears N46°W 7.9' scribed "1/4 S1 BT".
A burned Larch 7" bears S74°E 28.7' scribed "1/4 S6 BT".

Description of monument and accessories I establish to perpetuate the original location of this corner:

A 5/8"X30" rebar driven flush bears N57°30'E 38.17' with a red plastic cap scribed CJ STOUT OPLS 2632.

A 5/8"X30" rebar driven flush bears S87°30'E 28.18' with a red plastic cap scribed CJ STOUT OPLS 2632.

A 5/8"X30" rebar driven flush bears S13°W 14.70' with a red plastic cap scribed CJ STOUT OPLS 2632.

A 5/8"X30" rebar driven flush bears N30°30'W 17.87' with a red plastic cap scribed CJ STOUT OPLS 2632.

Witness: Shawn Parsons
7/29/03

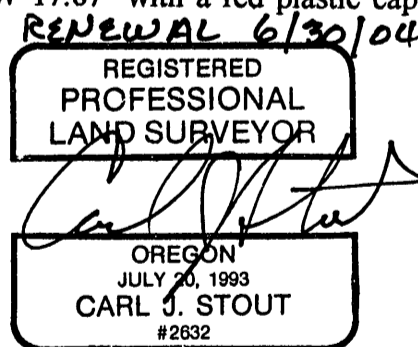

Office of County Surveyor, County of Grant, State of Oregon,
I hereby certify that the within instrument was filed in this office
For record on the 14 day of NOV, 2003.

Robert D. Bayen by _____
(COUNTY OFFICIAL) (DEPUTY)